

## Bathroom of the Week: Classic With Modern Touches

Designers give a Toronto couple a primary bathroom that reminds them of a favorite hotel



**Becky Harris** March 4, 2025

Houzz Contributor. Hi there! I live in a 1940s cottage in Atlanta that I'll describe as "collect... More

Save

Comment 5

Like 25

Share

In this new build for a Toronto couple and their two kids, designer Gabriele Guiducci considered his clients' needs, the natural light and sightlines. When laying out the 126-square-foot primary bathroom, he included a separate bathtub and shower, as well as a toilet room. He placed windows to maximize light and considered the best place for the bathroom door within their bedroom.

Once Guiducci was done with the architectural planning for the space, interior designer Terra Kushner took over with the finishes. "Our clients are classic with a modern twist," Kushner says. "They vibed with a Lower East Side Manhattan hotel, the Ludlow." The hotel mixes classic materials with hints of the neighborhood's gritty urban and artistic history. The result for the couple is a light-filled bathroom that feels timeless and handsome.



Photos by Niamh Barry

### Bathroom at a Glance

**Who lives here:** A family of four

**Location:** Toronto

**Size:** 126 square feet (12 square meters)

**Designers:** Gabriele Guiducci of [Geometra Design](#) (architecture) and Terra Kushner of [TK Creative](#) (interior design)

**Builder:** [Alexander Tencate Design Build](#)

The house sits on a tight lot, close to neighboring homes. So one of the first things Guiducci did when planning the bathroom was to look to the light. "Lighting was key," he says. "We did a sun study of the property and I wound up moving the driveway from one side of the house to the other

with sunlight and window placements in mind." His layout for the home allowed for a large east-facing window in the bathroom (seen here in the mirror's reflection) to let in the morning light. He also planned for a south-facing window in the toilet room. Using a clear glass door on the toilet room enables the entire bathroom to benefit from both windows.

To get a classic feel in the room, Kushner used a lot of light marble and porcelain finishes. To add contrast, warmth and a modern touch, she designed a bookmatched walnut vanity. The matte black wall-mounted faucets, high backsplash and sheet mirror also bring in clean, modern lines. The mirror-mounted sconces add a hint of urban Art Deco style that's both classic and modern.

Ceiling light: [Urban Archaeology](#).

[Find an interior designer on Houzz](#)



Guiducci planned for a generous shower stall that measures 4 by 5 feet. Matching the glass, framing and handle of the shower door to that on the toilet room door created a clean, cohesive feel. "All the lights are strategically placed to create interesting sightlines from each vantage point in the space," Kushner says. "For example, the sconce in the shower glows from the entrance, and the ceiling-mounted light over the bathtub warms the space."

The vibe of the Ludlow served as the jumping-off point for Kushner in terms of its timeless materials and classic design. Then she tailored things to suit her clients and their needs. The hotel's bathroom floors inspired one

particular detail. They're composed of mosaic tiles with striking black-and-white contrast. Kushner riffed off this idea, using a combination of 1-inch hexagonal off-white marble mosaic tiles and half-inch square tumbled black marble mosaic tiles. The dark outline creates a nice sense of scale. The hexagonal tiles continue up the walls to form the baseboards.

When choosing finishes, Kushner considered functionality and durability along with beauty. Accordingly, she used porcelain slabs for the countertop and bathtub surround. The small floor tiles provide much-needed grip in the bathroom. The floors are also heated.

[Find a local tile professional](#)



Both homeowners like to take baths, so Guiducci worked a 5-foot drop-in tub into the layout. Kushner finished the surround in porcelain with marble-like veining. Repeating this material throughout the room adds to the cohesive feel. The surround also maintains the bathroom's clean, modern lines.

The streamlined tub deck makes it easier to get in and out of the bathtub than a freestanding tub would, and it's easier to keep clean. It also provides space to place an item like a book or a drink.

[Shop for towels bars and holders](#)

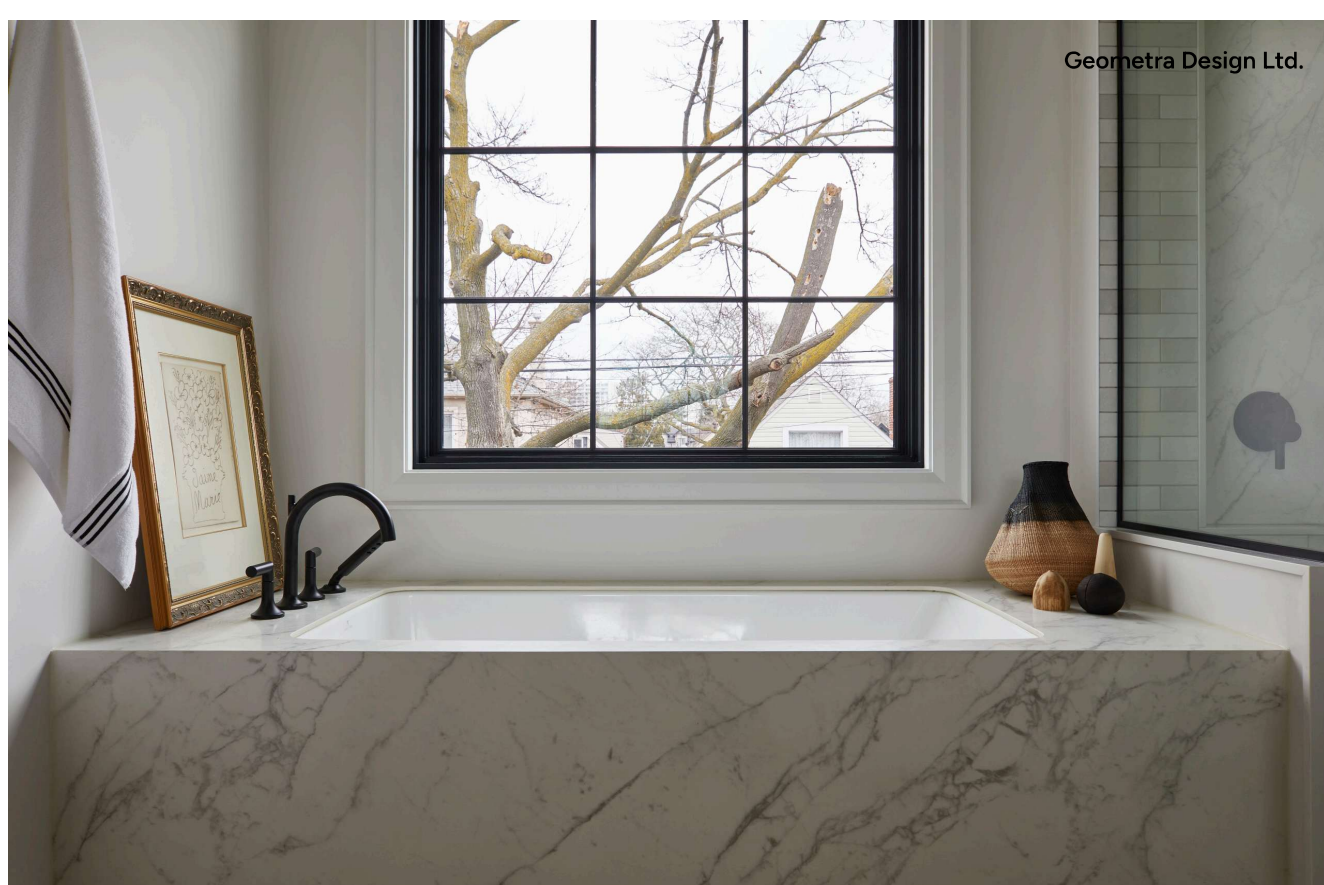

"My clients were moving from a suburban area into the city and they wanted to feel connected to the outdoors," Guiducci says. "I considered the sightlines when I placed this window. This included what they would be looking at while they were daydreaming in the bathtub."



Inside the shower, a niche houses the plumbing fixtures. Kushner used leftover porcelain to outline and back the niche. The matte black fixtures lend an urban element and strong contrast to the mix.

[Browse shower heads in the Houzz Shop](#)



Kushner added a niche in the toilet room for contrast, interest and display space. It matches the walnut she used on the vanity. This is a spot where the homeowners can add some eclectic and surprising touches.

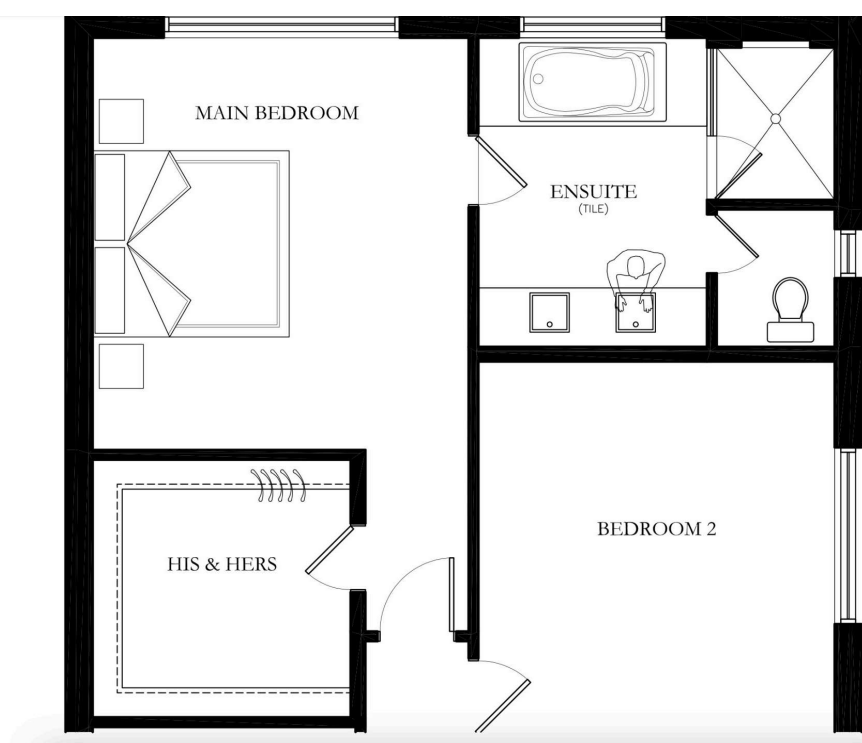

**Floor plan:** This is the primary suite. Guiducci is not a fan of closet and bathroom doors taking up wall space in a bedroom. "I usually like to create a little lobby rather than having closet and bathroom doors open directly into the bedroom. That was possible for the closet but not the bathroom here, so I pushed the bathroom door as close to the exterior wall as possible," he says. "This allows for more options when placing furniture, art or a TV on the bedroom wall."

**More on Houzz**

[Read more bathroom stories](#)

[Browse bathroom photos](#)

[Find a bathroom remodeler](#)

[Shop for your bathroom](#)

♡ Save

💬 Comment | 5

👍 Like | 25

🔗 Share

See 5 comments ▾